



# SITE PLAN

## INTRAUrBAN SOUTHLANDS

BUILDING 1



BUILDING 2

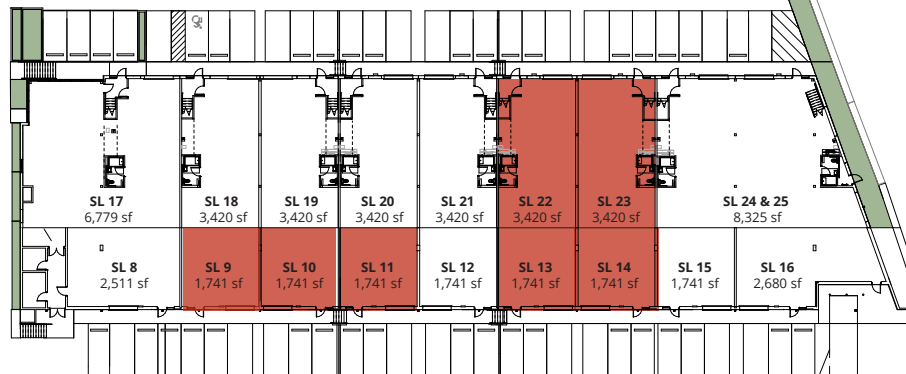

BUILDING 3

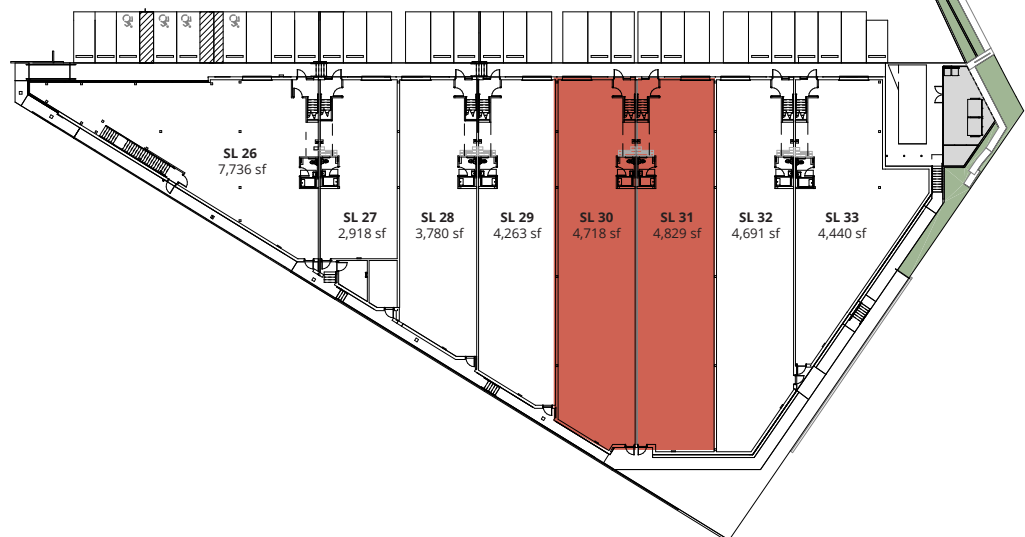

 SOLD

[INTRAUrBAN.ca/SOUTHLANDS](https://intraurban.ca/southlands)

**pcurban.**  
Potential. Created.

**N NICOLA**  
WEALTH

**AVISON**  
**YOUNG**

**CUSHMAN &**  
**WAKEFIELD**

© 2024 Avison Young. All rights reserved. E. & O.E.: The information contained herein was obtained from sources that we deem reliable and, while thought to be correct, is not guaranteed Avison Young Commercial Real Estate Services, LP ("Avison Young")

All materials, measurements, specifications, renderings and layouts are preliminary and displayed for illustrative purposes only. The information contained herein is subject to change at any time without notice.



# BUILDING 2

## INTRAUrBAN SOUTHLANDS

### LOWER LEVEL

8698 BARNARD STREET,  
VANCOUVER

MARCH 2024



Strata Lot	Total (sf)
SL 8	2,511
SL 9	SOLD
SL 10	SOLD
SL 11	UNDER CONTRACT
SL 12	1,741
SL 13	SOLD
SL 14	SOLD
SL 15	1,741
SL 16	2,680

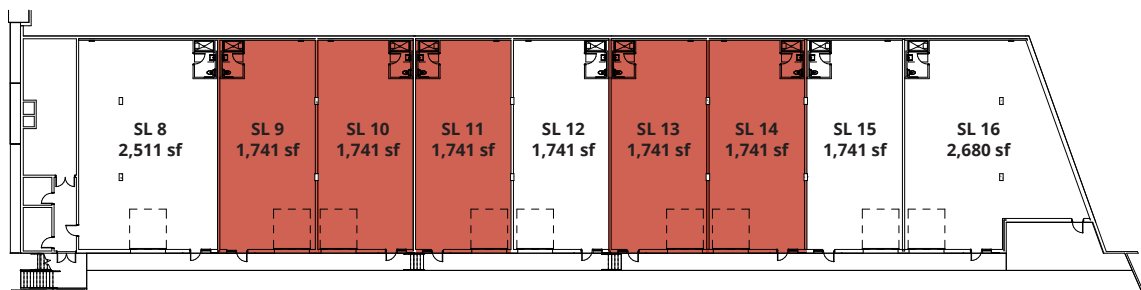

**SOLD**

[INTRAUrBAN.ca/SOUTHLANDS](https://intraurban.ca/southlands)

**pcurban.**  
Potential. Created.

**NICOLA**  
WEALTH

**AVISON**  
**YOUNG**

**CUSHMAN & WAKEFIELD**

© 2024 Avison Young. All rights reserved. E. & O.E.: The information contained herein was obtained from sources that we deem reliable and, while thought to be correct, is not guaranteed Avison Young Commercial Real Estate Services, LP ("Avison Young")

All materials, measurements, specifications, renderings and layouts are preliminary and displayed for illustrative purposes only. The information contained herein is subject to change at any time without notice.



# BUILDING 2

## INTRAURBAN SOUTHLANDS

### GROUND FLOOR & MEZZANINE

8698 BARNARD STREET,  
VANCOUVER

MARCH 2024



Strata Lot	Ground Floor (sf)	Mezzanine (sf)	Total (sf)
SL 17	4,616	2,163	6,779
SL 18	2,315	1,105	3,420
SL 19	2,315	1,105	3,420
SL 20	2,315	1,105	3,420
SL 21	2,315	1,105	3,420
SL 22	SOLD		3,420
SL 23	SOLD		3,420
SL 24 & 25	5,854	2,471	8,325
<b>Total</b>	<b>24,360</b>	<b>11,264</b>	<b>35,624</b>

INTRAURBAN.CA/SOUTHLANDS





# BUILDING 2

## INTRAUrBAN SOUTHLANDS

### GROUND FLOOR

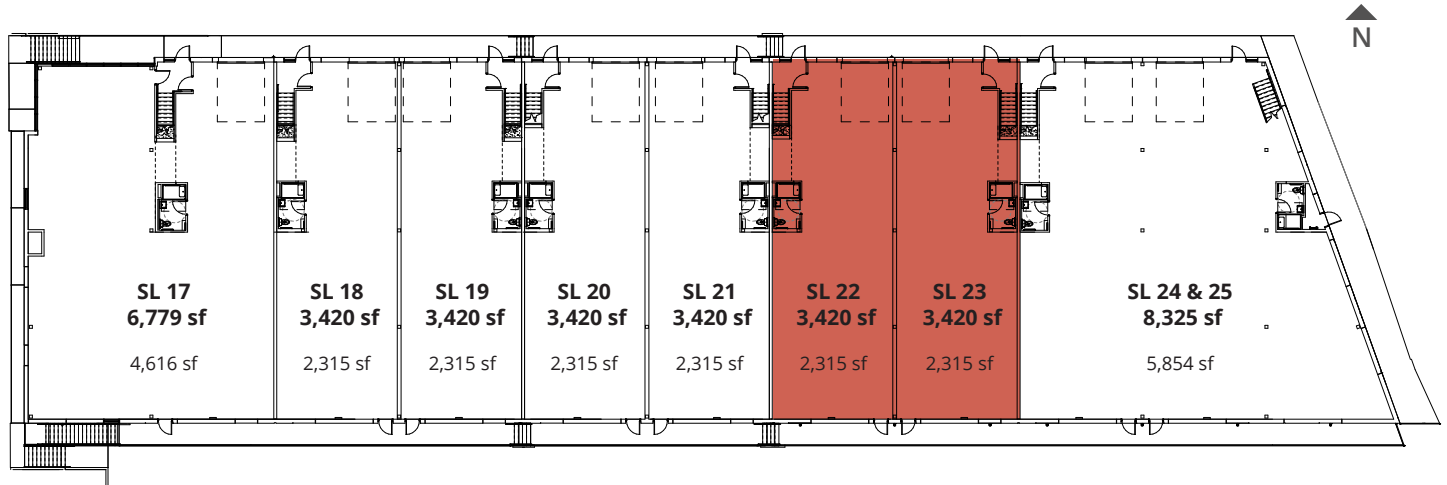

### MEZZANINE

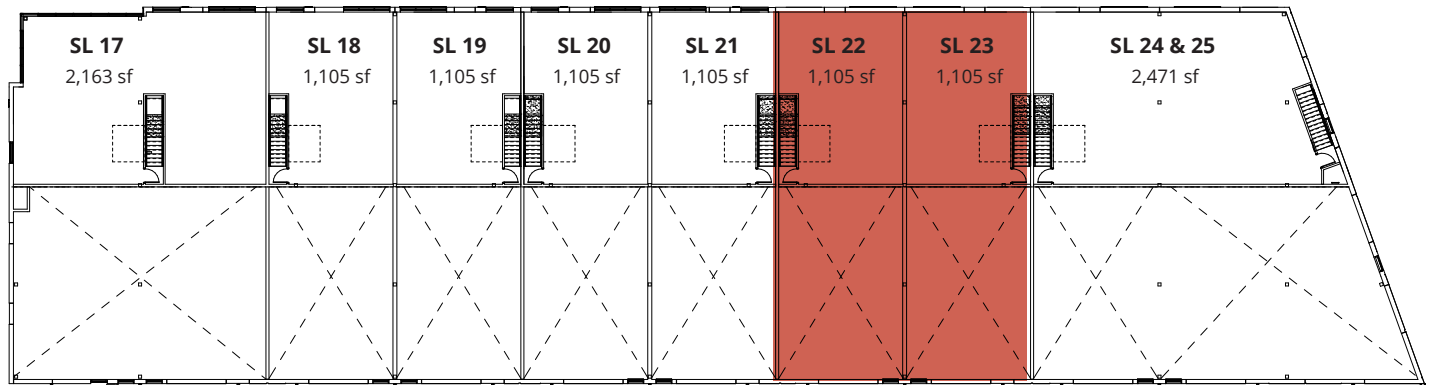

[INTRAUrBAN.ca/SOUTHLANDS](https://intraurban.ca/southlands)

**pcurban.**  
Potential. Created.

**NICOLA**  
WEALTH

**AVISON**  
**YOUNG**

**CUSHMAN &**  
**WAKEFIELD**

© 2024 Avison Young. All rights reserved. E. & O.E.: The information contained herein was obtained from sources that we deem reliable and, while thought to be correct, is not guaranteed Avison Young Commercial Real Estate Services, LP ("Avison Young")

All materials, measurements, specifications, renderings and layouts are preliminary and displayed for illustrative purposes only. The information contained herein is subject to change at any time without notice.

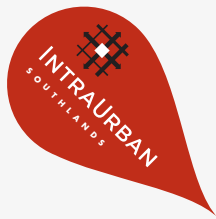

# BUILDING 3

## INTRAURBAN SOUTHLANDS

### GROUND FLOOR & MEZZANINE

8710 BARNARD STREET,  
VANCOUVER

MARCH 2024



Strata Lot	Ground Floor (sf)	Mezzanine (sf)	Total (sf)
SL 26	3,862	3,874	7,736
SL 27	1,813	1,105	2,918
SL 28	2,675	1,105	3,780
SL 29	3,158	1,105	4,263
SL 30	SOLD		4,718
SL 31	SOLD		4,829
SL 32	3,586	1,105	4,691
SL 33	3,171	1,269	4,440
<b>Total</b>	<b>25,602</b>	<b>11,773</b>	<b>37,375</b>

INTRAURBAN.CA/SOUTHLANDS





# BUILDING 3

## INTRAUrBAN SOUTHLANDS

### GROUND FLOOR

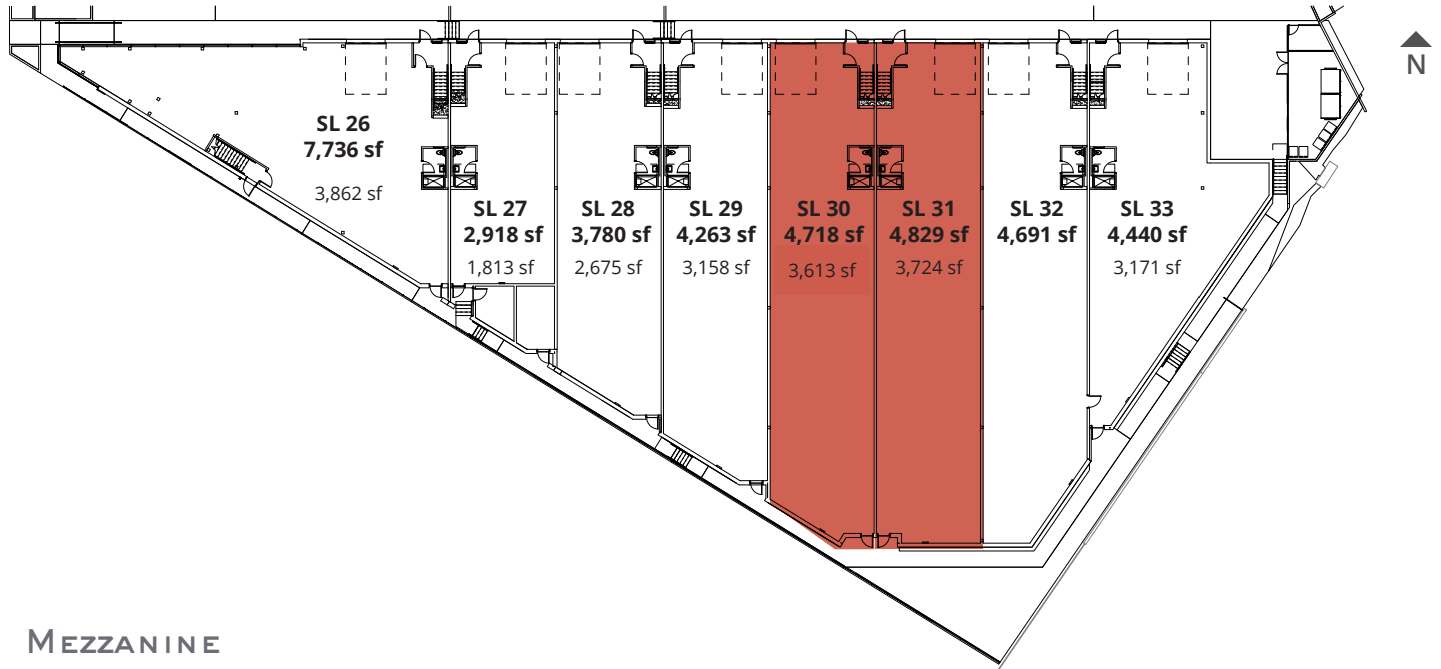

### MEZZANINE

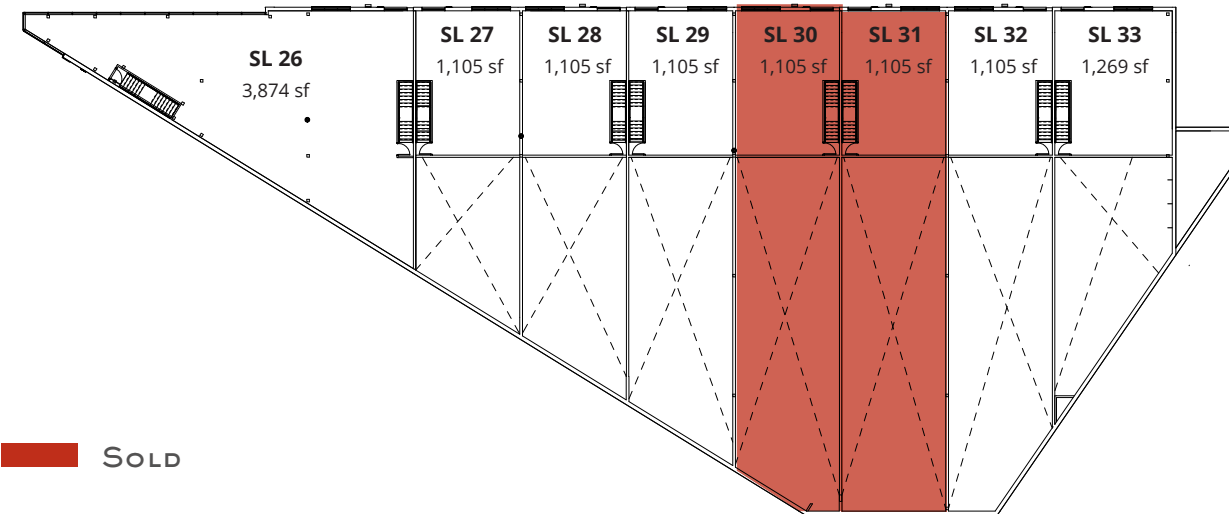

 SOLD

[INTRAUrBAN.ca/SOUTHLANDS](https://intraurban.ca/southlands)

**pcurban.**  
Potential. Created.

**NICOLA**  
WEALTH

**AVISON**  
**YOUNG**

**CUSHMAN &**  
**WAKEFIELD**

© 2024 Avison Young. All rights reserved. E. & O.E.: The information contained herein was obtained from sources that we deem reliable and, while thought to be correct, is not guaranteed Avison Young Commercial Real Estate Services, LP ("Avison Young")

All materials, measurements, specifications, renderings and layouts are preliminary and displayed for illustrative purposes only. The information contained herein is subject to change at any time without notice.